



One-Piece Moldings, Two-Piece Moldings & Rivets

Standard One-Piece Polypropylene Moldings

Product:

For professional looking panel installations, and maximum moisture sealing effectiveness, use Crane Composites one-piece, non-staining, polypropylene moldings.

Purpose:

For use with panel thickness 0.075", 0.09", 0.12"

Division Bar | DB

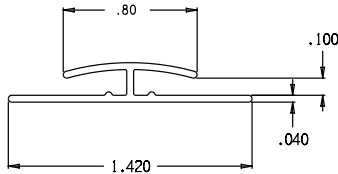
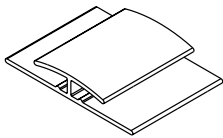

Inside Corner | IC

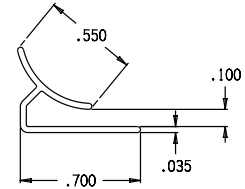
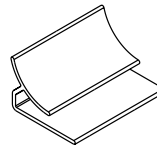

Outside Corner | OC

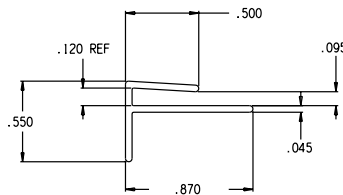
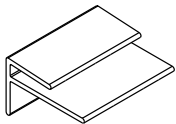

Cap | CP

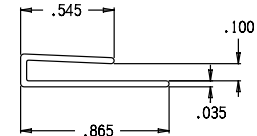
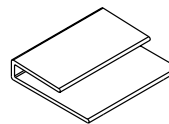

Inside Angle | IA

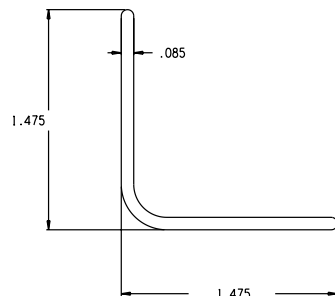
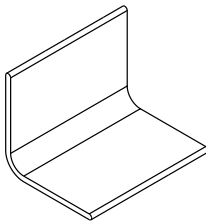

Outside Angle | OA

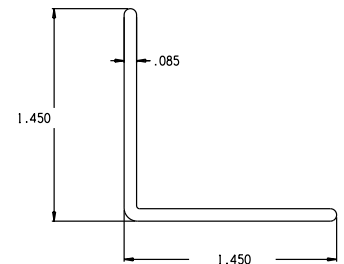
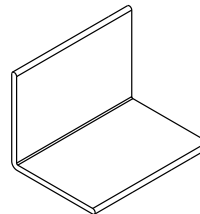

Standard Nylon Drive Rivets

Product:

Non-staining nylon drive rivets in matching panel colors are designed for quick and easy installation using only a hammer and drill. When used with silicone sealants, drive rivets maintain an effective moisture seal as well as providing excellent mechanical fastening for panels.

Available in White, Cream, Beige, Silver, and Gray

Purpose:

See **Table A** for rivet size and corresponding panel thickness.

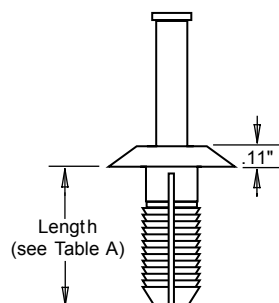

Table A

Panel Thickness	Rivet Length
.09" to .125"	.75"
.09" to .25"	1"
.25" to .5"	1.5"

Standard One-Piece Vinyl Moldings for Laminated FRP Panels

Product:

For professional looking Laminated FRP panel installations, and maximum moisture sealing effectiveness, use one-piece, non-staining vinyl moldings.

Purpose:

For use with Laminated FRP installations up to 0.437" thick.

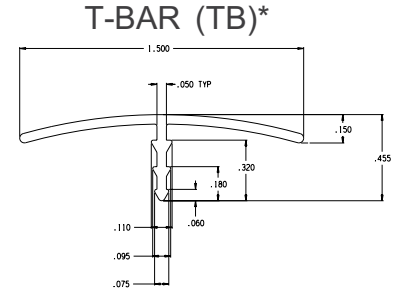
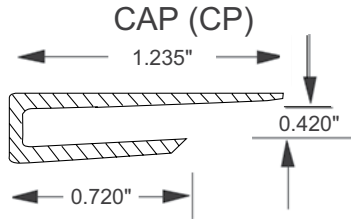
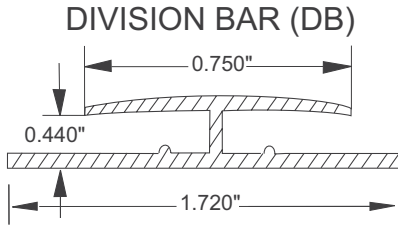

INSIDE CORNER (IC)

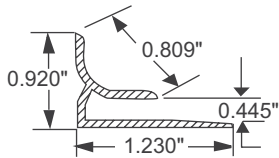

OUTSIDE CORNER (OC)

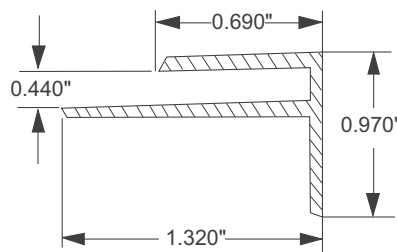

* T-Bar is extruded Polypropylene

Inside and Outside Angles are also available for Glasbord Laminated (Kemply) installations. Please refer to Standard One-Piece Polypropylene Moldings on the other side of this page for dimensions

Two-Piece Polypropylene Moldings

Product:

For professional looking and convenient installations, use two-piece batten and snap-on trim non-staining polypropylene moldings. Available in white only.

Purpose:

Improved Installation time. Panel and molding can be installed in separate operations. Screws can be used to secure base and panel. Holes must be oversized.

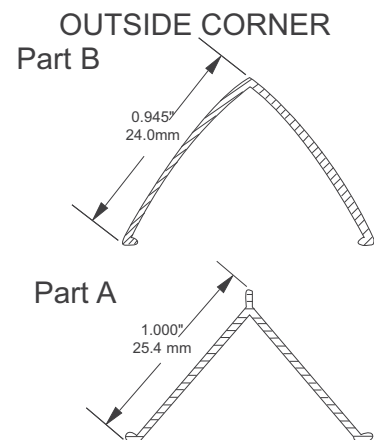
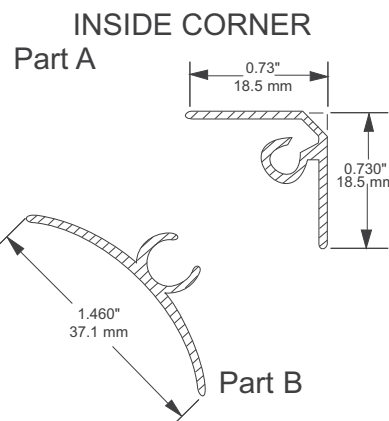
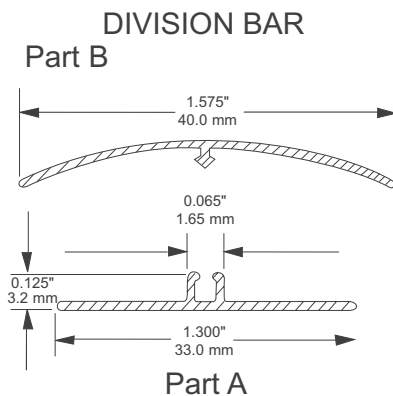

www.frp.com | 1.800.435.0080 | 1.815.467.8666 (fax) | salesbp@cranecomposites.com

Crane Composites is the manufacturer of Glasbord, Sequentia, Sanigrad II and a variety of other fiberglass reinforced plastic (frp) composite wall panels. Inspired by the Kemlite tradition, Crane Composites has over 55 years of experience in Commercial Building Products and is a recognized industry leader in frp applications.

We believe all information given is accurate. It is offered in good faith, but without guarantee. Since conditions of use are beyond our control, all risks are assumed by the user. Nothing herein shall be construed as a recommendation for uses which infringe on valid patents or as extending a license under valid patents.

Form 6220 | Rev. 19 | 2.11 | (5678)

